





LIGHTING STAND

483T 3 SCT Wind-Up Stand w/Auto Self-Locking device

 181cm 71.3"	 380cm 149.7"	 22.4kg 49.4lbs
 128cm 50.4"	 30kg 66.1lbs	 KC-100



3 sections.
 Dia.: 55mm, 45mm, 38mm
 Leg dia.: 30mm
 Chrome plated steel stand
 w/geared column.
 2 risers extend simultaneously at one
 elevation of 4.4cm per handle turn.
 Safety cable ensures simultaneous
 retrieval of all sections.
 With 1 leveling leg

Auto Self-Locking device
 stop unexpected drop-off,
 and make operation safer.
 (PAT.ZL2006201577133.0)



Lock position

The safety pin will auto
 insert to the holey tube
 when wind-up.



Unlock position

The inside spring will bring
 the safety pin back.



483-BP Base Plate
 Set for three available with
 481,482, 483T, 470 stands





OPTIONAL ACCESSORY
KS-056 LATERN BAR
 6 x lantern T Bar
 1420mm long with
 Dia. 28mm stud

Features of Wind-up stand :

The stand top mounted by a steel bolt
 through the top tube that offers most
 sturdy and solid assembly.



The tension of break shoe can be
 adjusted with Allen wrench.



To prevent the tube falling off rapidly,
 the wind-up handle should be inserted
 in between center pole and legs.



Leveling legs should be set into
 horizontal at leaning location.



Velcro is supplied to fasten the legs
 for better storage and transportation.



Top section tube can be adjusted by
 stepping on foot step.



Casters are optional for easily moving
 the stand. The stand foot is rugged
 zinc-casting. Dia.: 100mm with brake
 and M10 attachment. A set is for three
 (KC-100).



484 HEAVY DUTY WIND-UP STAND

3 Sections, DIA.: 70mm, 60mm, 50mm
 2 Risers extend simultaneously at one elevation of 4.4cm per handle turn
 Leg DIA.: 35mm With 1 leveling leg
 Center tube & legs: Stainless steel
 Top 2 sections: Chrome plated steel
 With Auto Self-Locking Device

L 196cm **H** 386cm **W** 39kg
FO 180cm **max** 80kg **T** 28mm

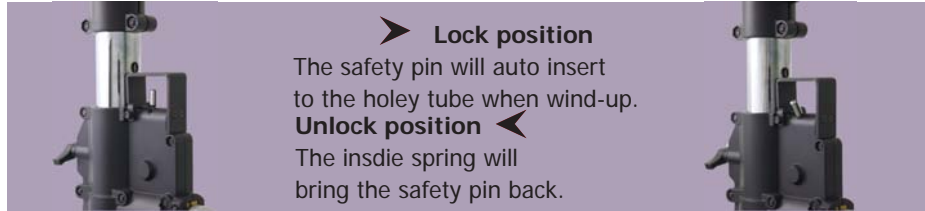

▲ 28mm socket with 3 side holes for wind bracing kit

▼ Auto Self-Locking device stop unexpected drop-off and make operation safer

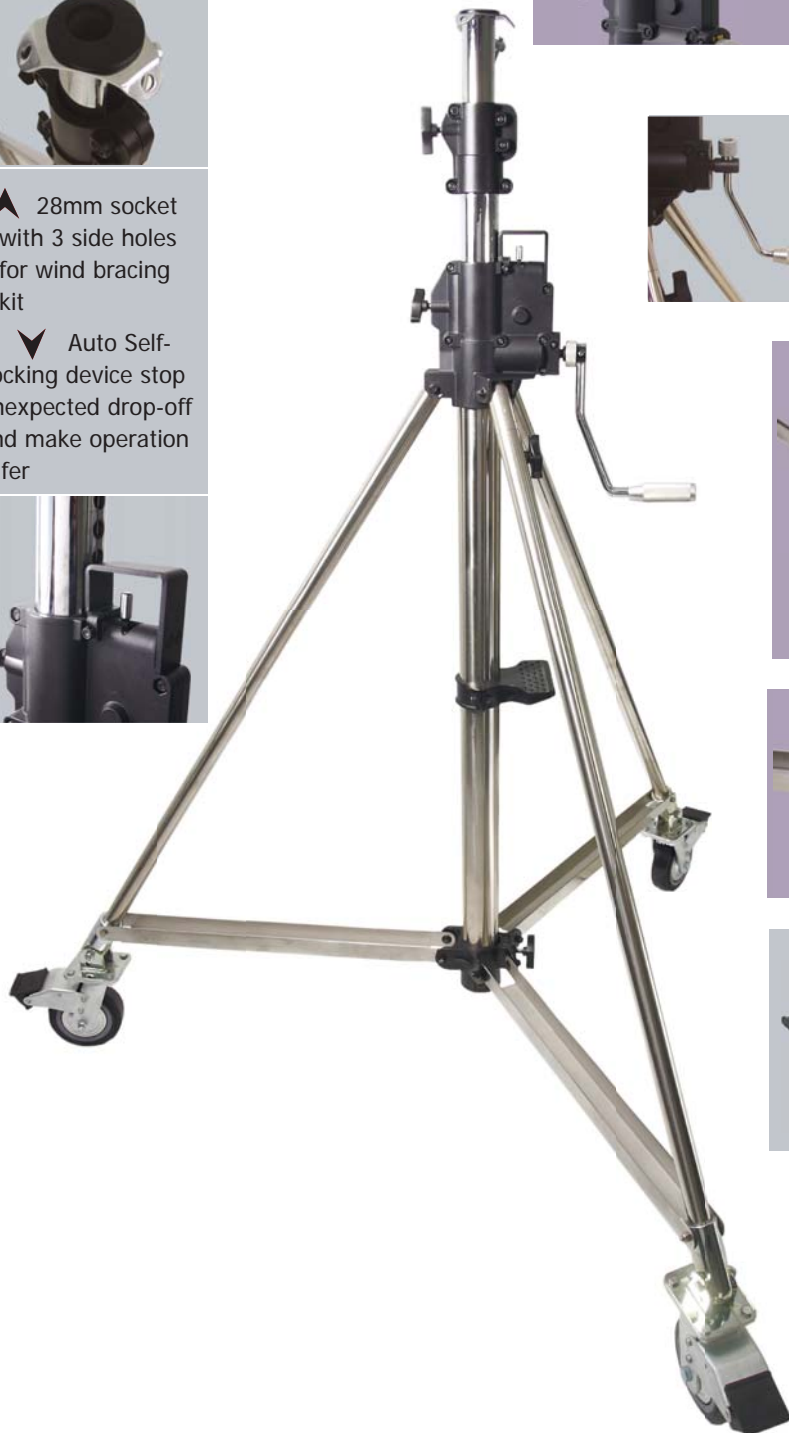
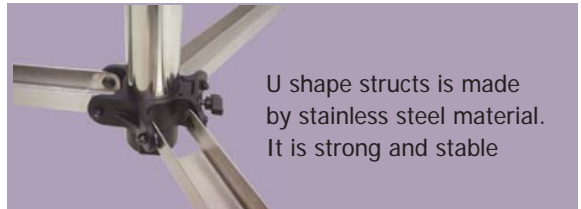
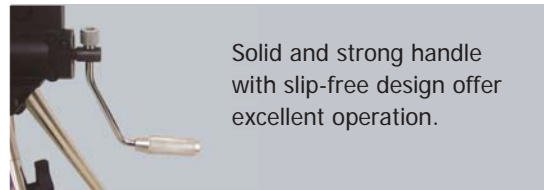

482 2 SECTIONS WIND UP STAND

CHROME PLATED STEEL STAND WITH GEARED COLUMN

Elevation: 2.2mm per handle turn,
2 Sections, Dia.: 55, 45mm, 1 Riser, Leg Dia.
30mm, One leveling leg

 165cm	 245cm	 18.5KG
 128mm	 45KG	 28mm

481 Wind-up Followspot Stand

CHROME PLATED STEEL STAND WITH GEARED COLUMN

Elevation: 2.2mm per handle turn,
2 Sections, Dia.: 55, 45mm
1 Riser, Leg Dia. 30mm, One leveling leg,
with auto-lock

 110cm	 145cm	 13.5KG
 110mm	 40KG	 28mm

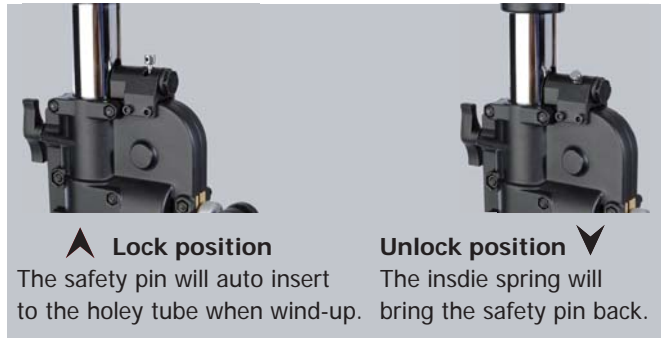

OPTIONAL ACCESSORIES
KC-100 CASTER
Dia. 80mm w/brake, Set for three

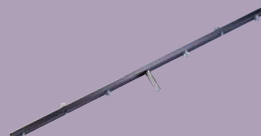

KS-056 LATERN BAR
6 x lantern T Bar
1420mm long with; Dia. 28mm stud

470 FOLLOWSPOT STAND

CHROME PLATED STEEL CENTERPOST

1 Riser, 2 Sections, Dia.: 40, 50mm
 Leg Dia. 30mm, One leveling leg, Memory collar

L 109cm **H_{max}** 147cm **W** 8.70KG
K 110cm **↓_{max}** 40KG **T** 28mm



OPTIONAL ACCESSORIES
KC-100 CASTER FOR 470 STAND
 Dia. 100mm w/brake, Set for three



KS-080 FOR 470 STAND
 Ball Race M10 stud
KS-082 FOR 470 STAND
 Ball Race M12 stud



KS-040 FOR 470 STAND
 28mm Pin w/M10 thread & Dia.12cm plate
KS-042 FOR 470 STAND
 28mm Pin w/M12 thread & Dia.12cm plate

226M MASTER COMBO HD STAND

CHROME PLATED STEEL STAND

3 Sections, DIA.: 40, 35, 30mm
 2 Riser, Leg DIA. 22mm with leveling leg, spring cushioned

L 132cm **H_{max}** 338cm **W** 9.15KG
K 132cm **↓_{max}** 40KG **T** 28mm



OPTIONAL ACCESSORIES
KC-080R CASTER FOR 226M STAND
 Dia. 80mm w/brake, Set for three

SANDBAG

Kupo sand bag is constructed from denier polyester canvas. It can be filled with sand or anything else to secure the light stand. Each side of the bag has a hand strap, butterfly handle and center handle, using a box pattern to ensure a durable attachment. The sandbag is shipped empty for convenience and economy, and available in 15, 25, 35 pounds.

Item number:

- KSD-1680A Sand bag 15 pounds
- KSD-1680B Sand bag 25 pounds
- KSD-1680C Sand bag 35 pounds

Butterfly Handle

